

# general notes

1. IT SHALL BE THE RESPONSIBILITY OF THE CONTRACTOR OR PERMITEE TO CONTACT "UNDERGROUND SERVICE ALERT U.S.A." TOLL FREE AT 1-800-227-2600 FORTY-EIGHT (48) HOURS PRIOR TO START OF CONSTRUCTION, FOR LOCATION OF POWER, TELEPHONE, OIL AND NATURAL GAS UNDERGROUND FACILITIES. CONTRACTOR OR PERMITEE SHALL ALSO CONTACT THE APPROPRIATE AGENCY FOR THE LOCATION OF CABLE T.V., WATER, SEWER, DRAINAGE OR UNDERGROUND FACILITIES.

2. THE CONTRACTOR SHALL POSSESS A CLASS "A" or "C-12" LICENSE AT THE TIME THE CONTRACT IS AWARDED.

## M<sup>etric</sup> datum:

HORIZONTAL CONTROL FOR POINTS 8065-8067 AS PUBLISHED IN THE CITY OF SAN LUIS OBISPO 1999 HORIZONTAL CONTROL NETWORK. CITY NETWORK IS BASED ON THE NORTH AMERICAN DATUM OF 1983 (NAD83) EPOCH DATE 1991.35, ZONE 5 CALIFORNIA.

VERTICAL CONTROL BENCHMARK NO. 5-18A, AS PUBLISHED IN THE CITY OF SAN LUIS OBISPO 1996 BENCHMARK SYSTEM. CITY'S BENCHMARK SYSTEM IS GENERALLY 52MM HIGHER THAN THE NORTH AMERICA VERTICAL DATUM OF 1929 (NAVD29).

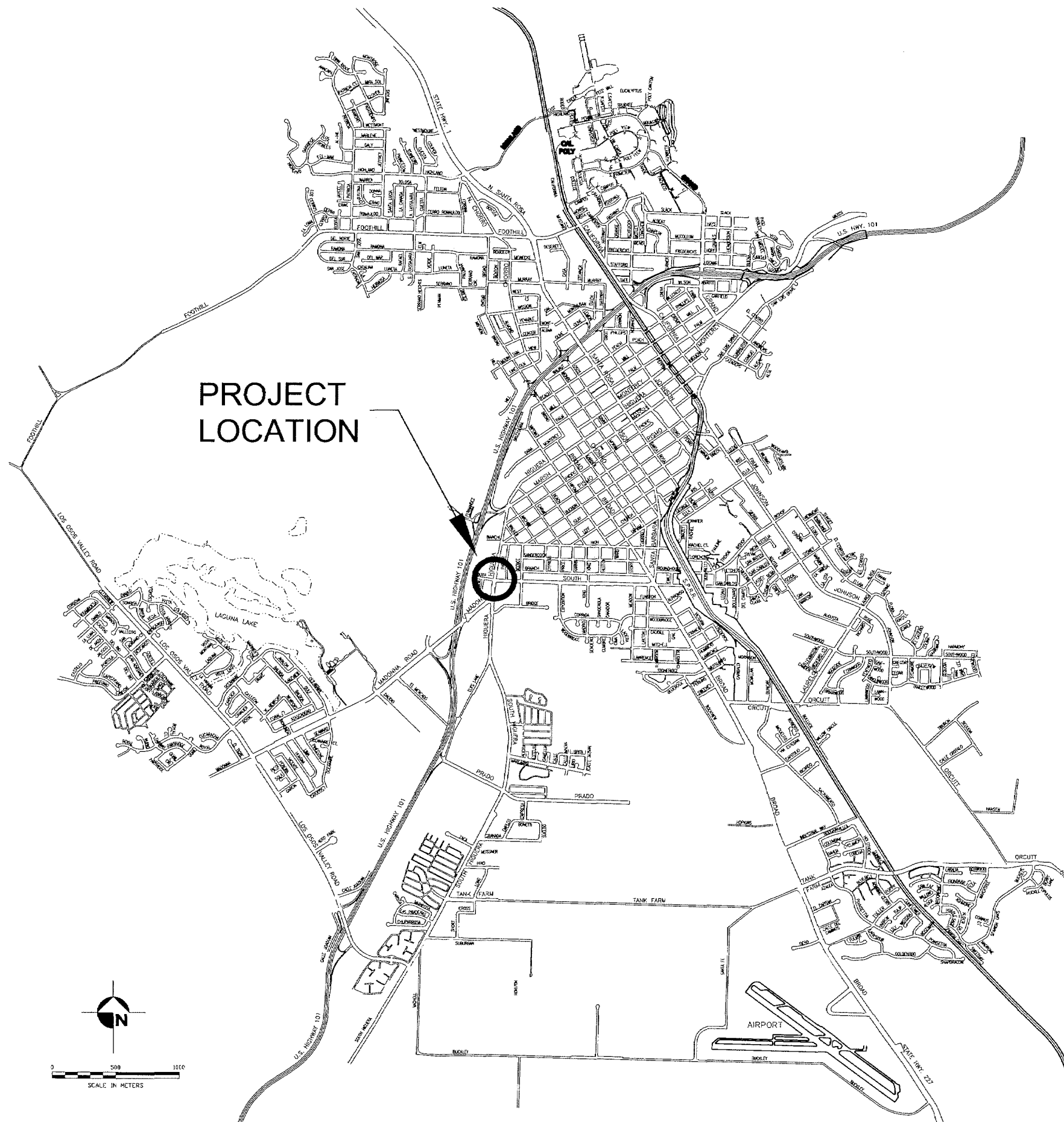

# index to plans

sheet no.	description
1	General Notes & Location Map
2	Roadway Plan & Section
3	Traffic Plan
4	Utilities
5	Detour Plan

 **city of  
san luis obispo**  
san luis obispo county, california

## STREET REPAIR HIGUERA & SOUTH STREETS

**RECORD DRAWINGS**

SPECIFICATION NO. 90159

APPROVED BY

  
Wayne A. Peterson  
City Engineer



R.C.E. 18598

DATE

11/00

FILE NO./LOCATION

SHEET

1 of 5

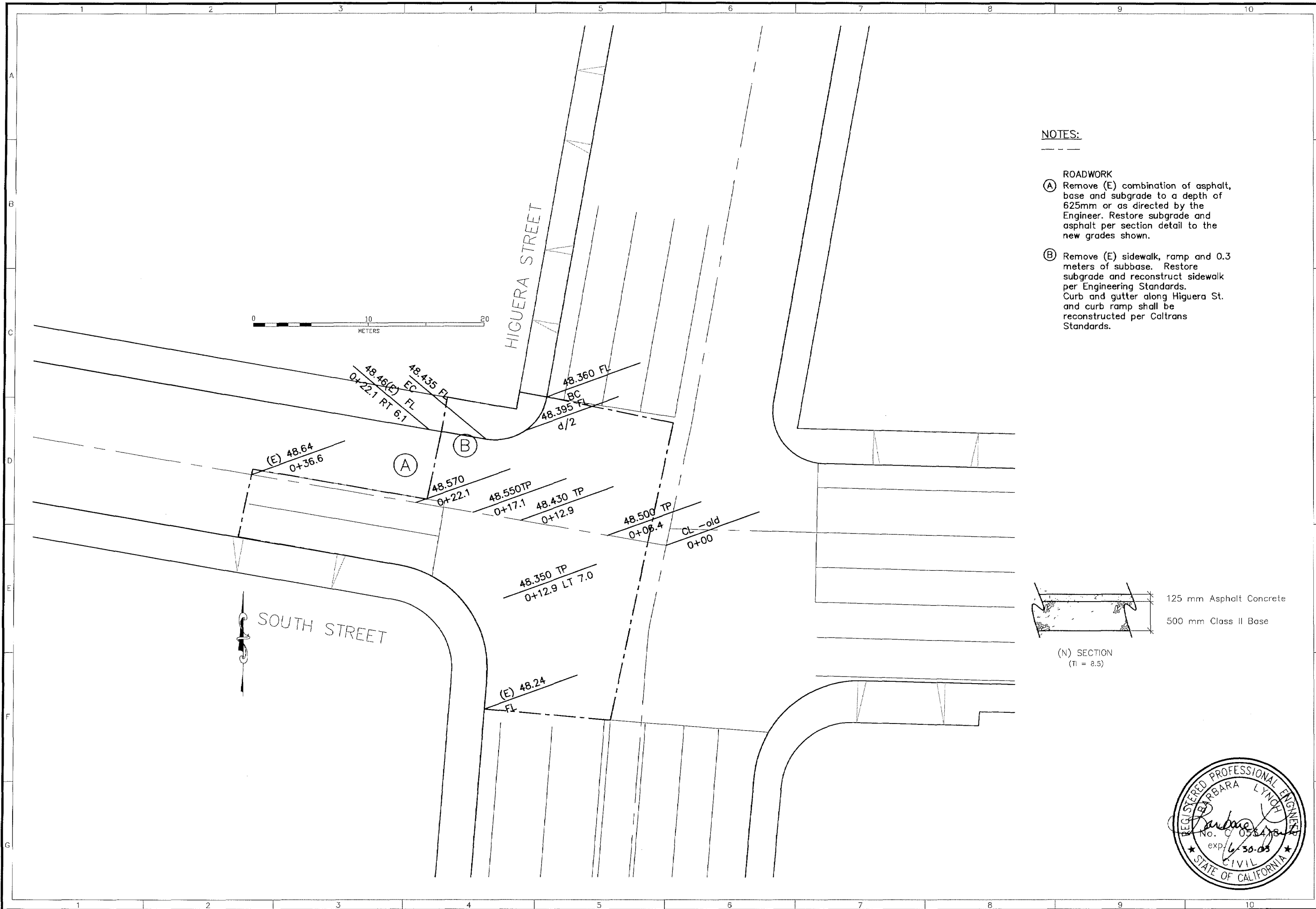

**NOTES:**

- ROADWORK**
- (A) Remove (E) combination of asphalt, base and subgrade to a depth of 625mm or as directed by the Engineer. Restore subgrade and asphalt per section detail to the new grades shown.
  - (B) Remove (E) sidewalk, ramp and 0.3 meters of subbase. Restore subgrade and reconstruct sidewalk per Engineering Standards. Curb and gutter along Higuera St. and curb ramp shall be reconstructed per Caltrans Standards.

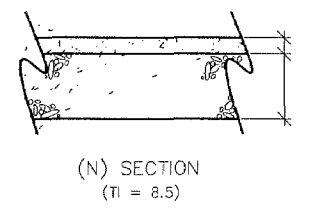

125 mm Asphalt Concrete  
500 mm Class II Base



REVISIONS:	Record Drawing

PROJECT TITLE:	Street Repair Project: Higuera & South Streets
SHEET TITLE:	Roadway Plan View
DESIGNED BY:	bl & dv
DRAWN BY:	bl
CHECKED BY:	bf
APPROVED BY:	wap
DATE:	Nov '00
CITY SPECIFICATION NO.:	90159
SHEET NO.:	2 of 5

**NOTES:**

- ROADWORK**
- (A) Remove (E) combination of asphalt, base and subgrade to a depth of 525mm or as directed by the Engineer. Restore subgrade and asphalt per section detail to the new grades shown.
  - (B) Remove (E) sidewalk, ramp and 0.3 meters of subbase. Restore subgrade and reconstruct sidewalk per Engineering Standards. Curb and gutter along Higuera St. and curb ramp shall be reconstructed per Caltrans Standards.

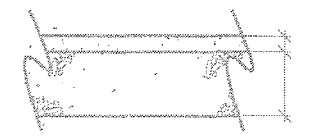

125 mm Asphalt Concrete  
500 mm Class II Base

(N) SECTION  
(N = 8.0)

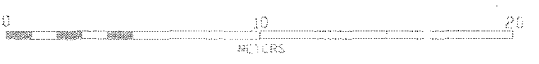

**SOUTH STREET**  
REMOVED ADDITIONAL PCC  
SIDEWALK DUE TO SETTLING  
AND DAMAGE. POURED 2-SK  
SLURRY AND PCC SIDEWALK  
PER CALTRANS REQUEST

**RECORD DRAWING**  
DATE: MARCH 2002 BY: JENN.



DESIGNED BY:  
bl & dr  
DRAWN BY:  
bl  
CHECKED BY:  
bl  
APPROVED BY:  
WJP  
DATE:  
Nov 00  
CITY SPECIFICATION NO:  
9C159  
SHEET NO.

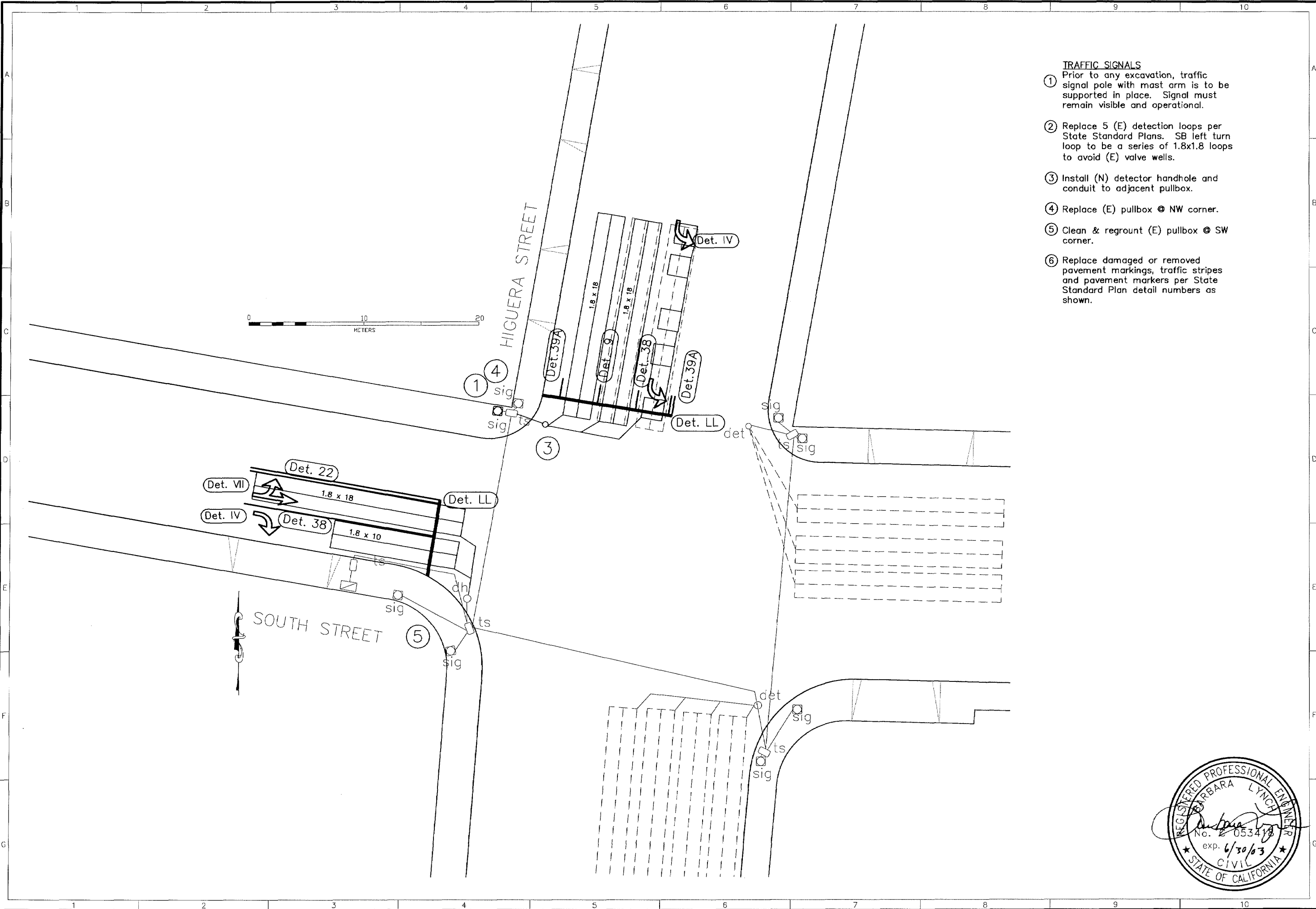

- TRAFFIC SIGNALS**
- ① Prior to any excavation, traffic signal pole with mast arm is to be supported in place. Signal must remain visible and operational.
  - ② Replace 5 (E) detection loops per State Standard Plans. SB left turn loop to be a series of 1.8x1.8 loops to avoid (E) valve wells.
  - ③ Install (N) detector handhole and conduit to adjacent pullbox.
  - ④ Replace (E) pullbox @ NW corner.
  - ⑤ Clean & reground (E) pullbox @ SW corner.
  - ⑥ Replace damaged or removed pavement markings, traffic stripes and pavement markers per State Standard Plan detail numbers as shown.

REVISIONS:

Record Drawing
----------------

Graphic Scale:  
H. -  
V. -

PROJECT TITLE:  
Street Repair Project: Higuera & South Streets

SHEET TITLE:  
Traffic Plan View

DESIGNED BY:  
bl & dv

DRAWN BY:  
bl

CHECKED BY:  
bf

APPROVED BY:  
wap

DATE:  
Nov '00



CITY SPECIFICATION NO.  
90159

SHEET NO.  
3 of 5

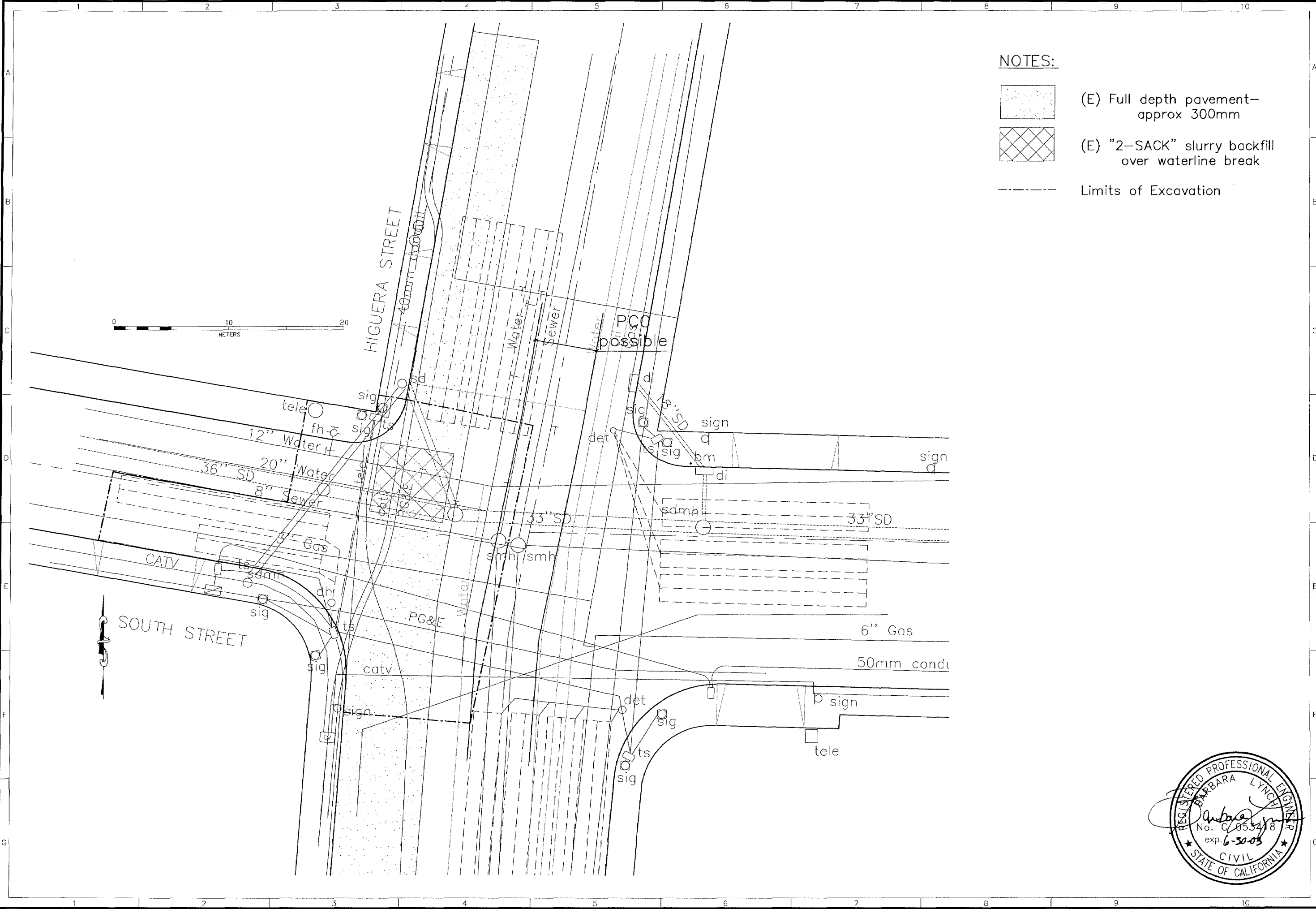

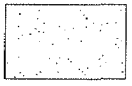

**NOTES:**

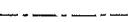

-  (E) Full depth pavement—approx 300mm
-  (E) "2-SACK" slurry backfill over waterline break
-  Limits of Excavation

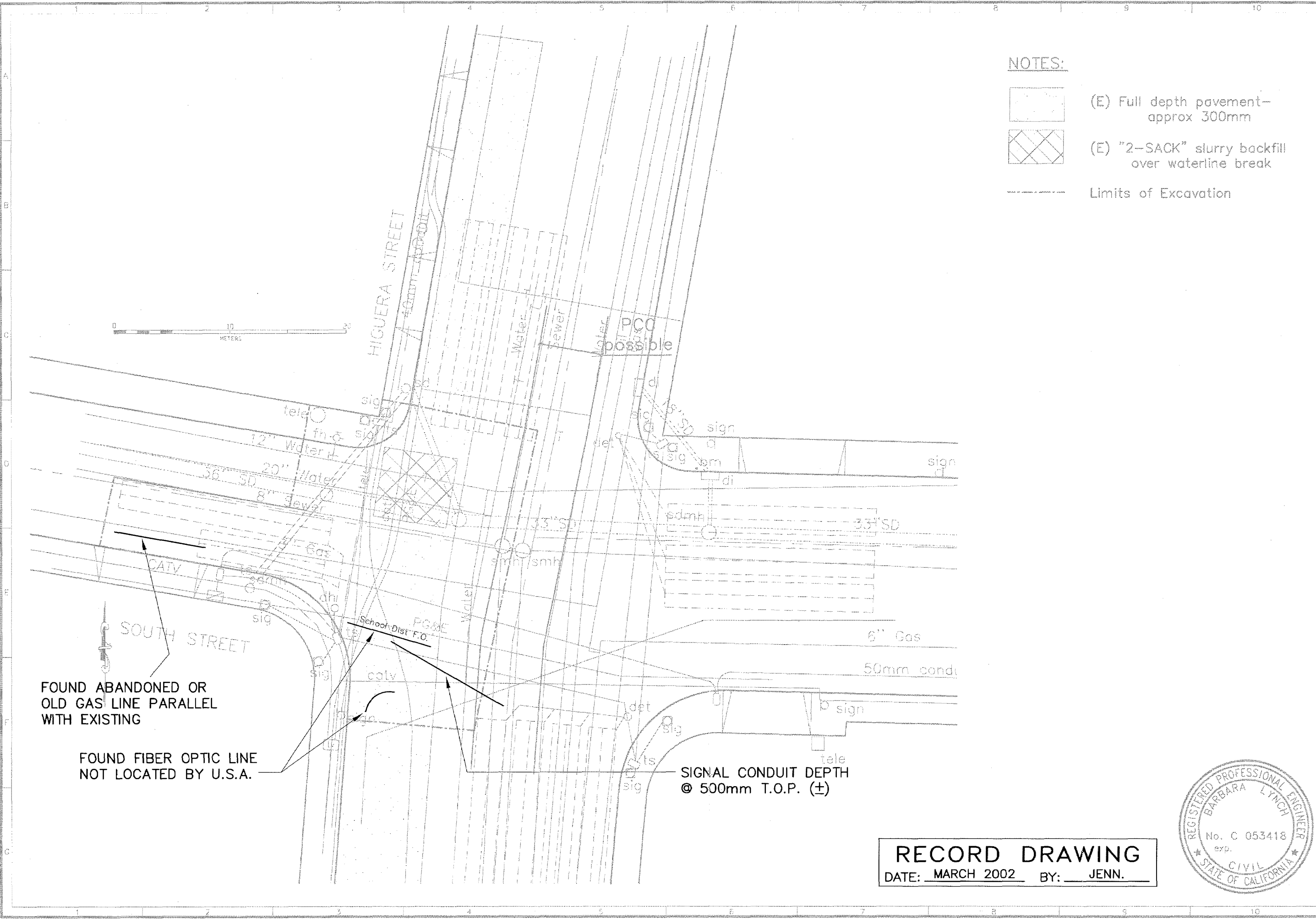

DESIGNED BY:	bl & dv
DRAWN BY:	bl
CHECKED BY:	bf
APPROVED BY:	wap
DATE:	Nov '00
CITY SPECIFICATION NO.:	90159
SHEET NO.:	4 of 5

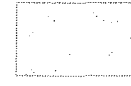

**NOTES:**

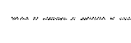
-  (E) Full depth pavement—approx 300mm
-  (E) "2-SACK" slurry backfill over waterline break
-  Limits of Excavation

FOUND ABANDONED OR OLD GAS LINE PARALLEL WITH EXISTING

FOUND FIBER OPTIC LINE NOT LOCATED BY U.S.A.

SIGNAL CONDUIT DEPTH @ 500mm T.O.P. (±)

**RECORD DRAWING**  
 DATE: MARCH 2002 BY: JENN.



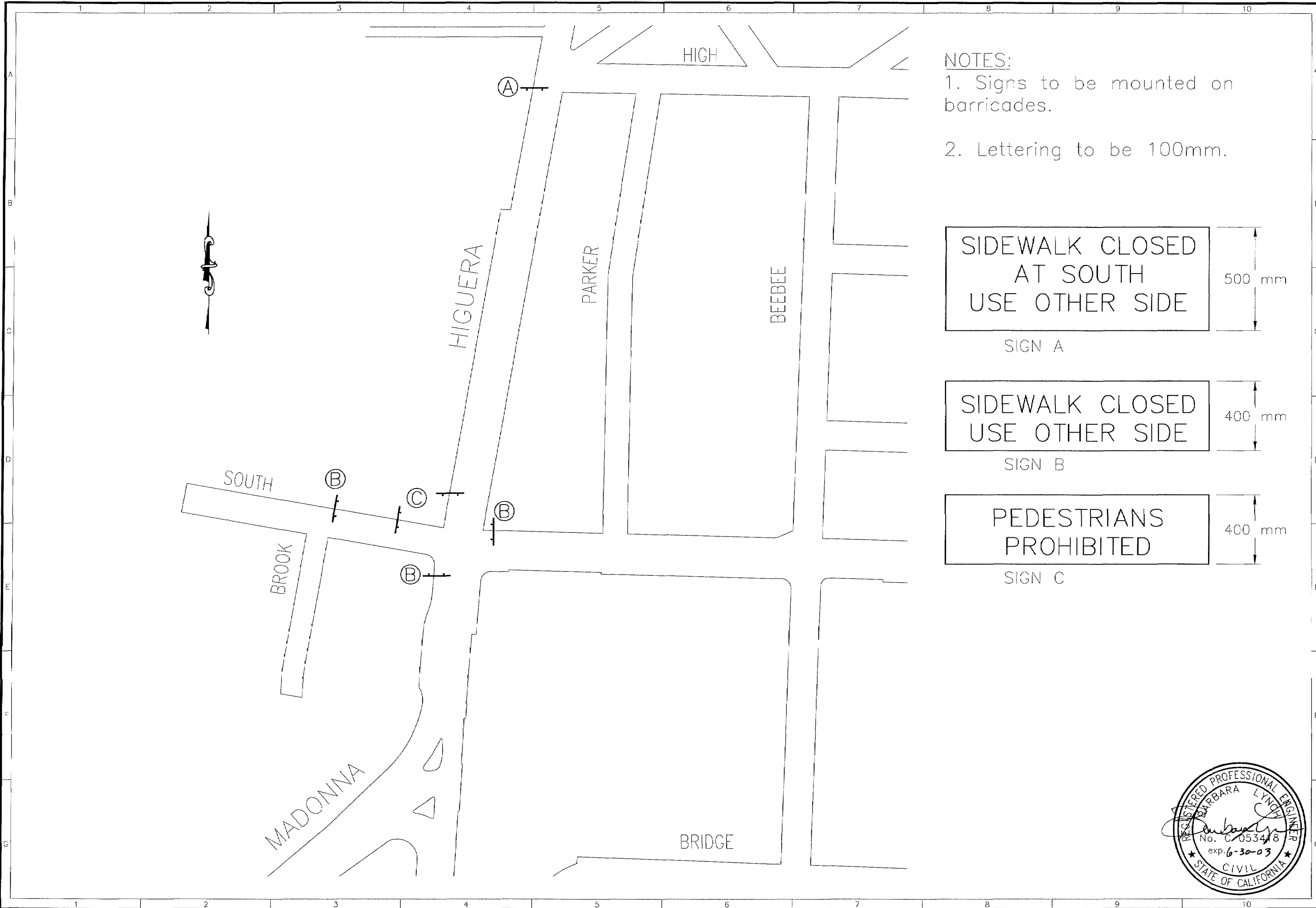

**NOTES:**

1. Signs to be mounted on barricades.
2. Lettering to be 100mm.

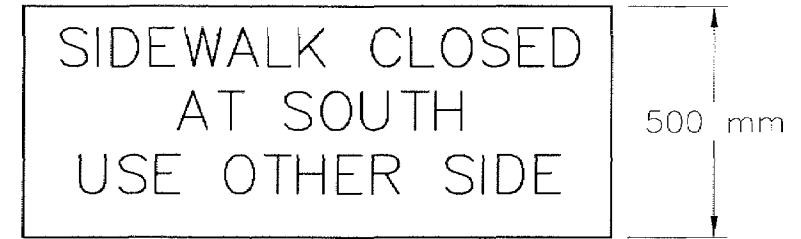

SIGN A

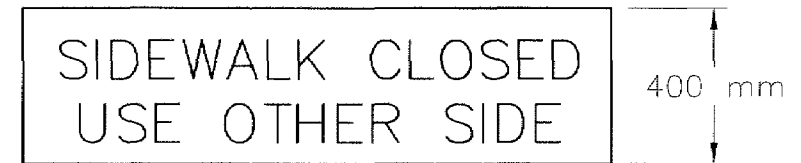

SIGN B



SIGN C

