

general notes

1. IT SHALL BE THE RESPONSIBILITY OF THE CONTRACTOR OR PERMITEE TO CONTACT "UNDERGROUND SERVICE ALERT U.S.A." TOLL FREE AT 1-800-227-2600 FORTY-EIGHT (48) HOURS PRIOR TO START OF CONSTRUCTION, FOR LOCATION OF POWER, TELEPHONE, OIL AND NATURAL GAS UNDERGROUND FACILITIES. CONTRACTOR OR PERMITEE SHALL ALSO CONTACT THE APPROPRIATE AGENCY FOR THE LOCATION OF CABLE T.V., WATER, SEWER, DRAINAGE OR UNDERGROUND FACILITIES.
2. THE CONTRACTOR SHALL POSSESS A CLASS "A" OR C34 LICENSE AT THE TIME THE CONTRACT IS AWARDED.

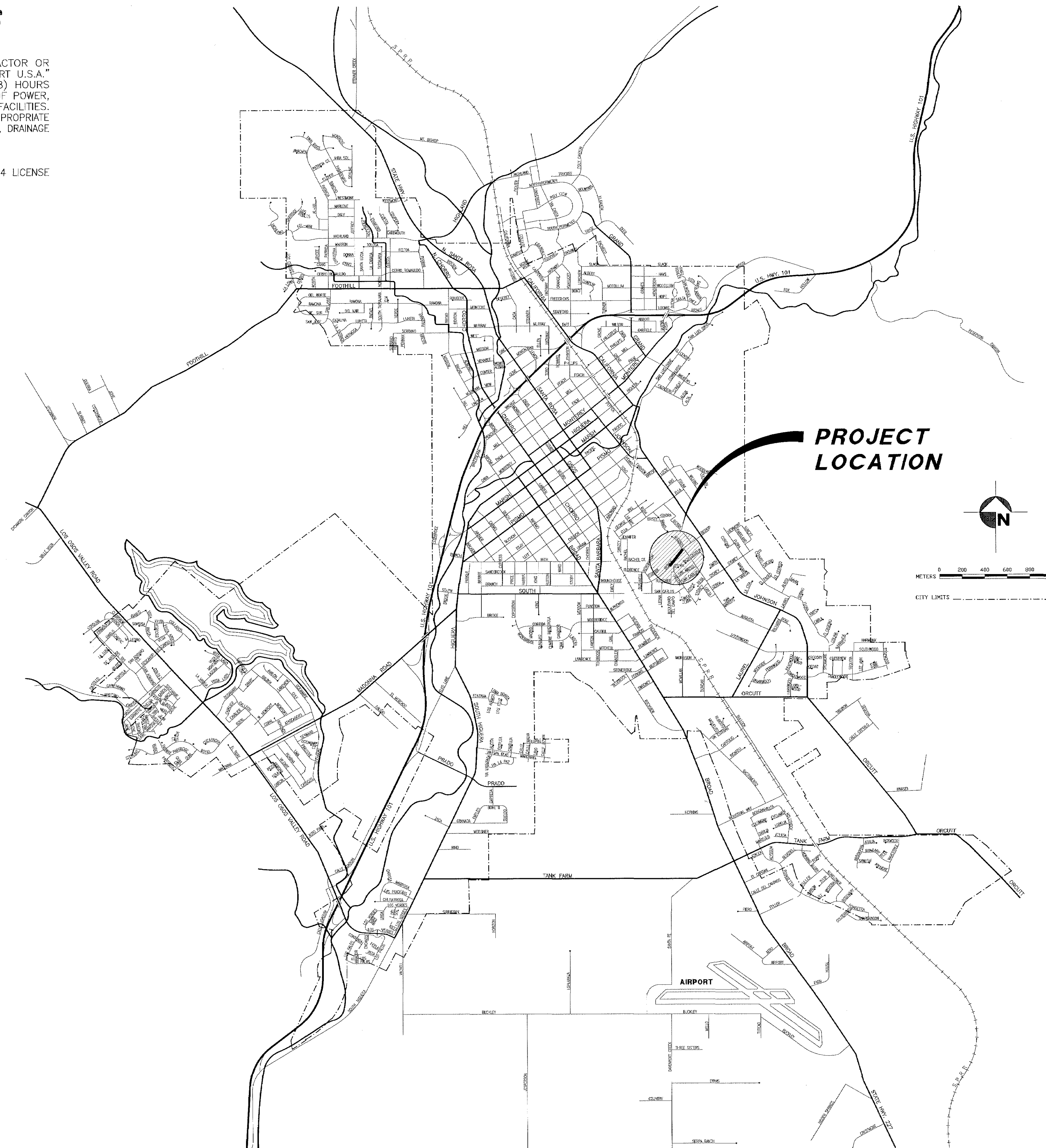

index to plans

sheet no.	description
1	COVER SHEET, VICINITY MAP
2	PLAN SHEET

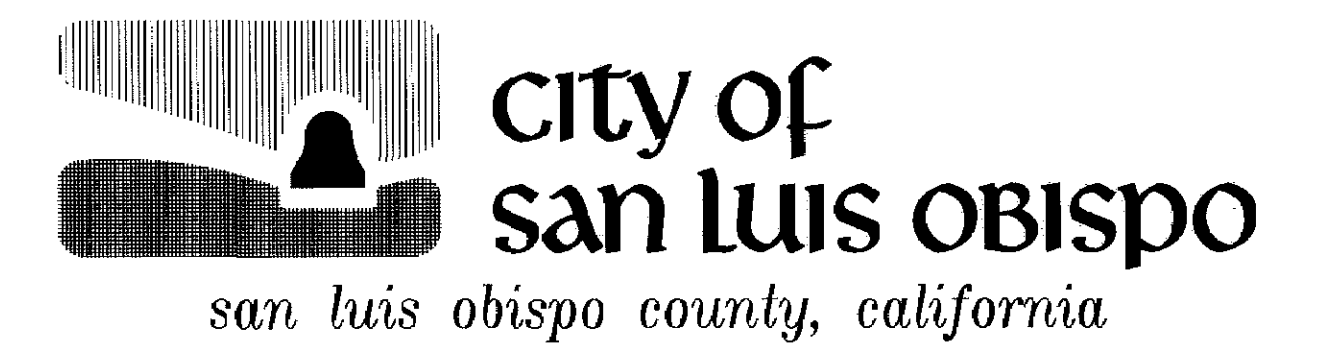

WATERMAIN IMPROVEMENT PROJECT

BISHOP STREET:
AUGUSTA to TERRACE HILL TANK

RECORD DRAWINGS

SPECIFICATION NO. **9201**

APPROVED BY

Gary W. Henderson R.C.E. 42240
Civil Engineer

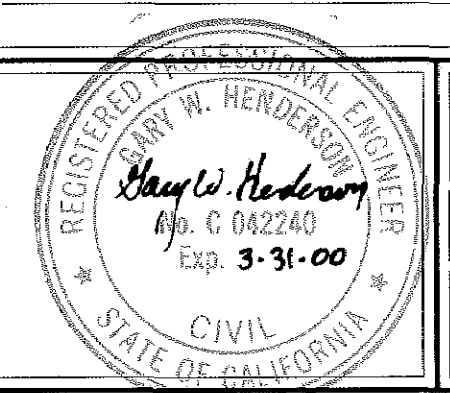

DATE
FEB 1998

FILE NO./LOCATION
0053 B

SHEET
1 OF 2

DATE	
BY	
NATURE / STATUS OF PLANS	

NOTES

1. Install 400mm ductile iron, mechanical joint, waterline per Trench Detail. Provide a minimum cover of 1 meter for the waterline.
2. Install 25mm polyethylene water service per Detail 6210 to existing water meter. Install fittings to reduce to 3/4" meter and install new meter box.
3. Install 50mm air/vac release assembly per Detail 6360.
4. Tie-in to existing 16" C.I. waterline. Install 400mm B.F. valve, solid sleeve and fittings as required per Detail 6330. Remove existing bend and thrust block as necessary to make the connection. The tie-in shall be done at night per Special Provisions.
5. Provide fittings, if necessary, to install new waterline below existing storm drain, sewerline and waterlines. Center full length of new 400mm D.I. pipe below sewerline.
6. Tie-in to existing 16" C.I. waterline. Install 400x400x300 tapping sleeve, 300mm gate valve, 400x300 reducer, 400mm-45° & 22 1/2° bends, and fittings as required per Detail 6330.
7. Install fire hydrant assembly per Detail 6310.
8. Install 75mm perforated drain pipe from high point in Bishop Street to tie-in point at existing sidewalk underdrain at driveway to Terrace Hill Tank. Provide a minimum 2% slope for drain pipe. Final 10 meters of drain pipe shall be 75mm D.I. pipe.
9. Realign drain pipe from waterline trench to back of sidewalk. Provide a minimum 2% slope to underdrain tie-in point. See Subsurface Drain Detail.
10. Tie-in existing fire hydrant to new 400mm D.I. waterline. Install 400x400x150 tee, thrust block, solid sleeve and fittings as required.
11. Cap and abandon waterline. Close existing valve, remove existing valve well, backfill and pave to abandon.
12. Cap and abandon waterline.
13. The Contractor shall be responsible for notifying U.S.A. and locating all underground facilities. The Contractor shall pothole and verify depths of all underground facilities and tie-in points prior to construction.
14. The depth to the top of the existing 8" waterline is approximately 2.7 meters.
15. Contractor shall restore monuments, striping and hydrant reflectors which are disturbed by construction activities.
16. Tie-in existing 2" water service per Details 6210 and 6220. City crews will install pressure regulator on customer service.

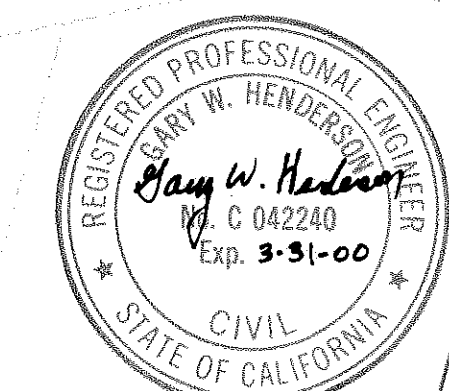
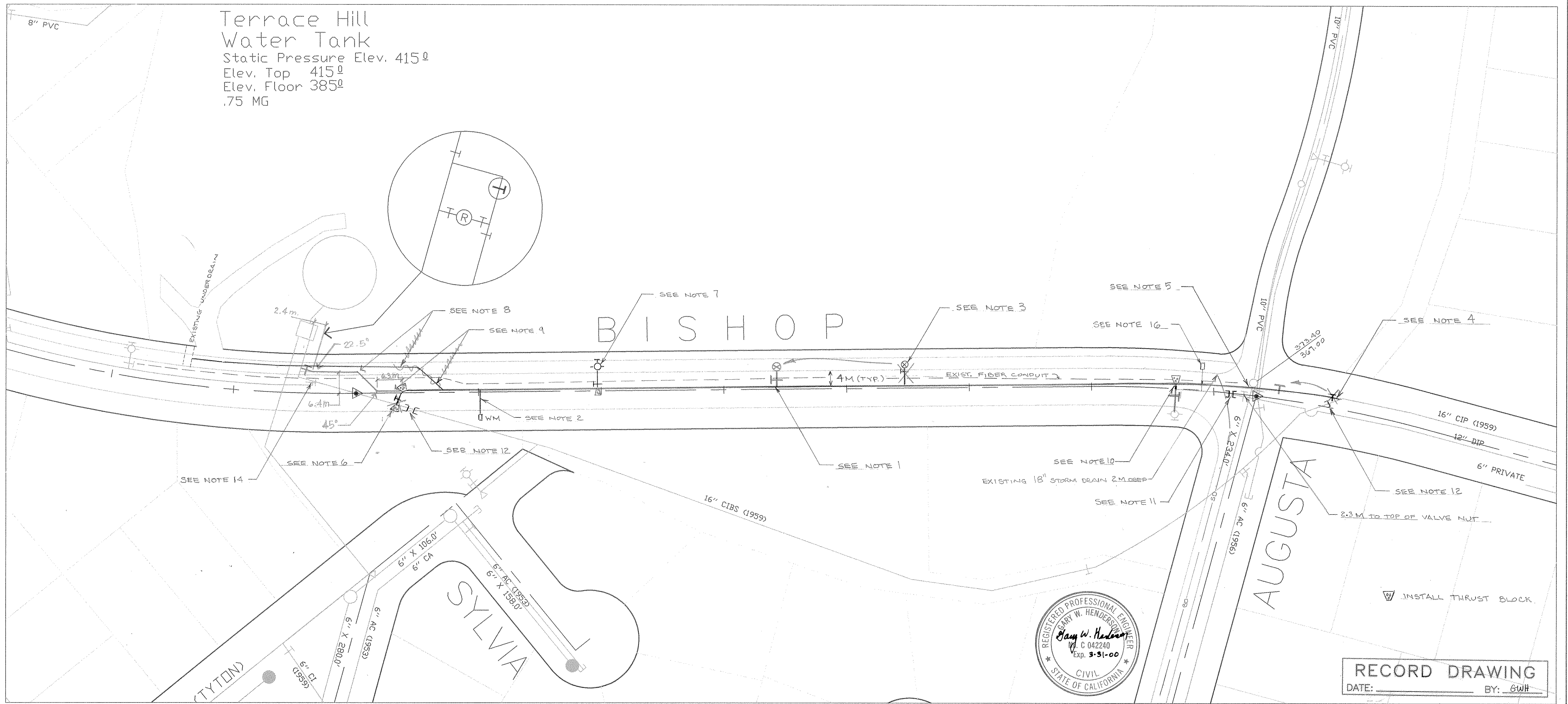

RECORD DRAWING
DATE: _____ BY: GWH



WATERMAIN IMPROVEMENT PROJECT
BISHOP ST. - AUGUSTA TO TERRACE HILL

DESIGNED BY	GWH	DATE	FEB 1998
DRAWN BY	GWH	SCALE	1:500
CHECKED BY	BL		
APPROVED BY UTILITIES DEPARTMENT			

PLAN	SPECIFICATION NO.	9201
	FILE NO./LOCATION	0052 B
	SHEET	2 OF 2