

PARCEL 1
(P.M. SLO 99-074)

PARCEL 2
(P.M. SLO 99-074)

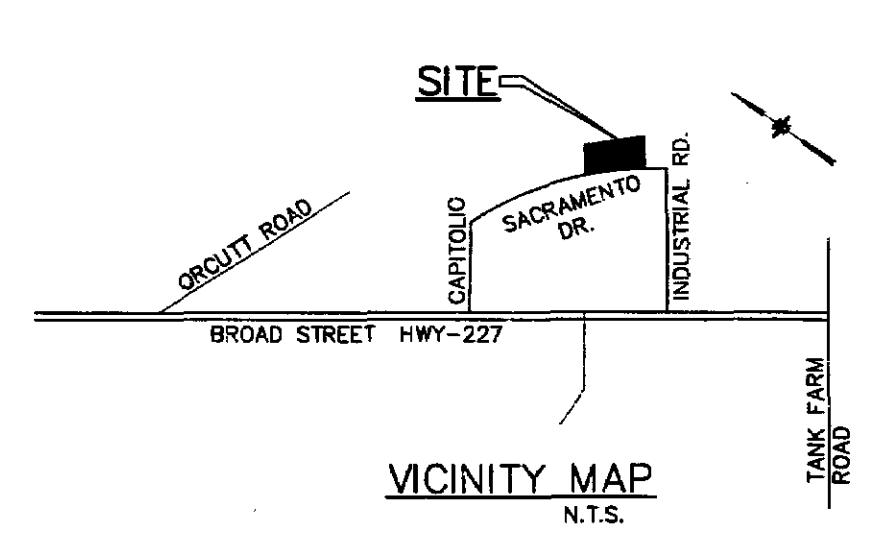
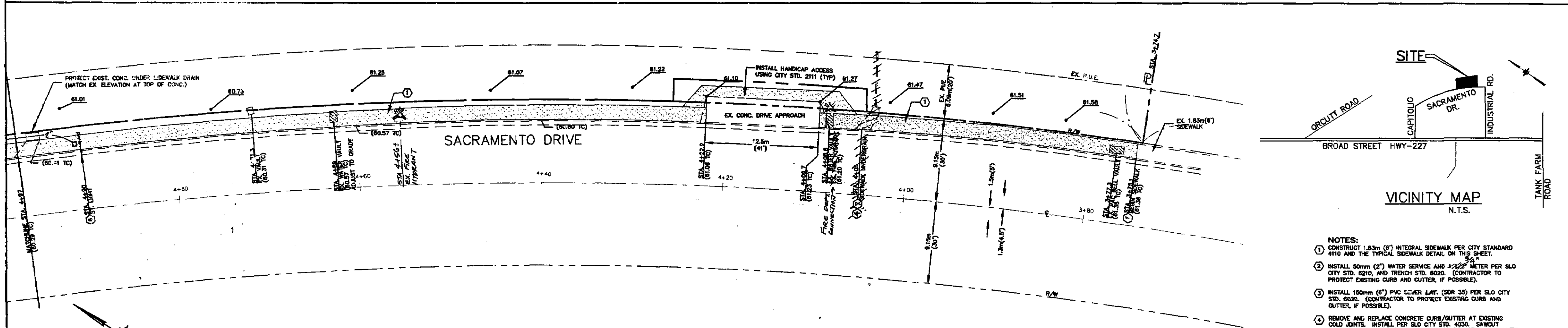
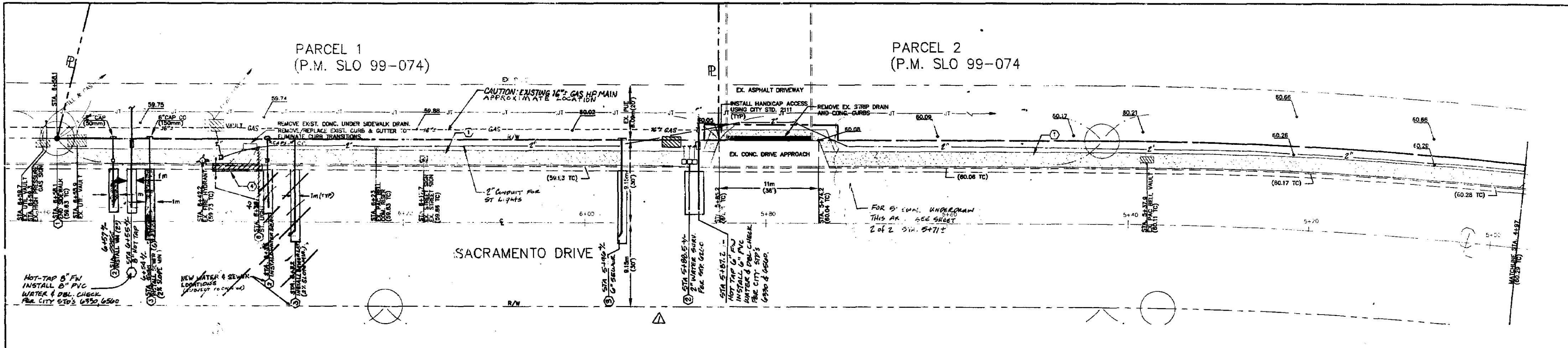

- NOTES:**
- CONSTRUCT 1.83m (6') INTEGRAL SIDEWALK PER CITY STANDARD 4110 AND THE TYPICAL SIDEWALK DETAIL ON THIS SHEET.
 - INSTALL 50mm (2") WATER SERVICE AND 1/2" METER PER SLO CITY STD. 6210, AND TRENCH STD. 6020. (CONTRACTOR TO PROTECT EXISTING CURB AND GUTTER, IF POSSIBLE).
 - INSTALL 150mm (6") PVC ECHER LAY. (SDR 35) PER SLO CITY STD. 6020. (CONTRACTOR TO PROTECT EXISTING CURB AND GUTTER, IF POSSIBLE).
 - REMOVE AND REPLACE CONCRETE CURB/GUTTER AT EXISTING COLD JOINTS. INSTALL PER SLO CITY STD. 4030. SAWCUT EXISTING PAVEMENT PER SAN LUIS OBISPO CITY STD. 4110, NOTES 849.
 - INSTALL STREET LIGHT PER SLO CITY STD. 7910 (8.7m HEIGHT, 100 WATT LIGHT).
 - CONSTRUCT SIDEWALK UNDERDRAIN PER DETAIL (A) 2

BOUNDARY DISCLAIMER:
THIS SURVEY WAS COMPILED FOR TENTATIVE MAP PURPOSES ONLY. THE BOUNDARY INFORMATION SHOWN HEREON IS INTENDED FOR ORIENTATION ONLY AND AS SUCH IS NOT INFERRED OR IMPLIED TO BE A BOUNDARY SURVEY.

BENCH MARK:
BASIS OF ELEVATIONS FOR THIS PROJECT IS BASED ON THE CITY OF SAN LUIS OBISPO BENCH MARK NO. 7-98 A FOUND LEAD AND TACK @ B.C.R. OF THE NORTH EAST CORNER OF INDUSTRIAL WAY AND SACRAMENTO. ELEVATION - 197.71 FEET.

STREET LIGHT NOTES:
STREET LIGHTS MUST BE SERVED FROM A PG & E SERVICE POINT NO MORE THAN 5 FEET FROM THE POINT.

SPECIFICATIONS:

- LUMINAIRES: PER STATE SPECIFICATION 86-8.01 (WITH "CUTOFF LIGHTS")
- BALLASTS: PER STATE SPECIFICATION 86-8.01A
- VOLTAGE: 120 VOLTS
- WIRE: ALUMINUM #6 FOR DUPLEX OR 1/0 FOR TRIPLEX.
- FUSE: TRON IN-LINE "HEY" SERIES BY BUSSMAN (OR EQUAL)
- CONDUIT: PER STATE SPECIFICATION 86.05, TYPE 3 OR 4 MIN SIZE 41 (1.5")
- PULL BOXES: INST WITH CONCRETE BOLT DOWN LIDS LABELED "STREET LIGHTS"
- IF MORE THAN ONE LIGHT IS FED FROM A SINGLE SOURCE, BALANCE TRANSFORMER LOADING BY USING ALTERNATE SIDE OF THE 220 SOURCE POWER.)

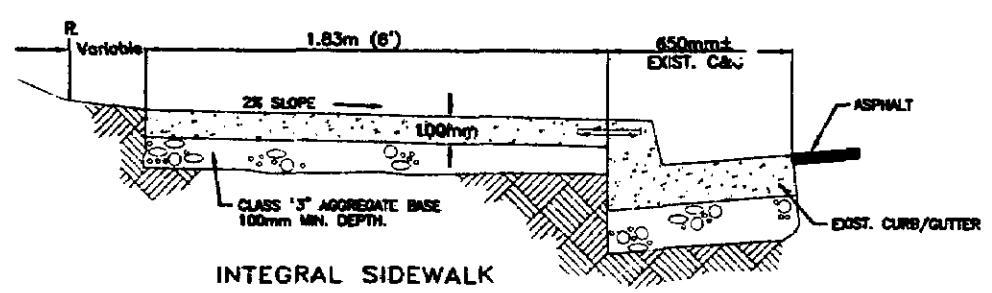

- NOTES:**
- CONCRETE: Class 3 P.C. Concrete, 50mm min. 100mm max. slump.
 - FINISH: P.C.C. sidewalk shall be given a broom finish.
 - SEALING & CURING: A pigmented sealing and curing compound shall be used in accordance with the provisions of the Department of Transportation Standards Specifications.
 - JOINTS: 12.5mm smooth bar dowels, 400mm long at 800mm O.C. at expansion joints and cold joints. To be grouted or sleeved on one end.
 - EXPANSION JOINTS: 6mm expansion material shall be placed at driveways, B.C.R.s. and at 30m intervals.
 - WEARFIELD PLANE JOINTS: Plastic puttop quot-joint strips or approved equal shall be at 8m O.C. and 40mm deep.
 - AT CORNERS BETWEEN SIDEWALK AND CURB: #10x150mm dowels shall be drilled in back of curb at 600mm O.C.

TYPICAL INTEGRAL SIDEWALK
N.T.S.

P.G. & E. APPROVAL (ELECTRIC):		REVISIONS			
DATE	No.	DESCRIPTION	APPROVED CIVIL ENGINEER	APPROVED CITY ENGINEER	
11/2/00	1	RECORD DWG FOR UTILITY CONN.	R.H.	2/6/00	12/1/00

Cannon ASSOCIATES
ENGINEERS
PLANNERS
SURVEYORS

364 Pacific Street
San Luis Obispo, CA 93401
(805) 544-7407

SACRAMENTO DRIVE SIDEWALK IMPROVEMENTS STA.3+75.10 TO STA. 6+58.1

CITY OF SAN LUIS OBISPO, CA.

COMMUNITY DEVELOPMENT DIRECTOR: *NA* DATE: *1/10/00*

CITY UTILITIES ENGINEER (SEWER & WATER): *W.D. Gil* DATE: *1/10/00*

PARKS DIRECTOR: *NA* DATE: *1/10/00*

CITY ENGINEER: *David R. Falkenberg* DATE: *1/10/00*

NOTICE

APPROVAL BY THE CITY DOES NOT GUARANTEE ACCURACY NOR COMPLETENESS OF THESE PLANS. IT DOES AUTHORIZE THE OWNER TO BUILD OR PROJECT HEREON. IT SHALL BE THE RESPONSIBILITY OF THE OWNER AND ENGINEER OF RECORD TO CORRECT ANY DEFICIENCIES THAT APPEAR BE DURING OR AFTER CONSTRUCTION. CITY SPECIFICATIONS AND ENGINEERING STANDARDS SHALL BE FOLLOWED UNLESS THEY ARE SPECIFICALLY WAIVED OR MODIFIED BY NOTES OR PLANS. THE ENGINEER OF RECORD SHALL PROVIDE REPRODUCIBLE "AS BUILT" PLANS AND THREE SETS OF MICROFORM PLANS TO THE CITY PRIOR TO PROJECT BEING ACCEPTED BY THE CITY.

DESIGN BY: *David R. Falkenberg* DATE: *1/10/00*

CHECKED BY: *CLW* DATE: *1/10/00*

CA JOB No.: *981221.02* DATE: *09/28/99* SHEET No.: *1* OF *2*

E:\PERIOD\9809\981221\METRIC\MP-PLN.dwg 1-10-00 08:11:43 AM Rsg/cp